

0.61mm THK COLORBOND®
LCP SPANLOCK® METAL ROOFING

0.61mm THK COLORBOND®
LCP HIGH-END FLASHING

0.61mm THK COLORBOND®
LCP Zed-END FLASHING
WITH SEALANT TAPE

0.48mm THK ZINCALUME®
LCP MULTIDECK® METAL SUBSTRATE

1 LAYER OF 50mm THK INSULATION,
DENSITY 100Kg/m³

1.00mm THK LCP GALV. SUB-GIRT
@ 600mm c/c / EVERY PURLIN

1 LAYER OF DOUBLE SIDED ALUM FOIL
VAPOUR/RADIANT BARRIER

1 LAYER OF ROOF MESH 3315

LCP HIGH TENSILE GALV. PURLIN

LCP VARIOUS CEILING/FASCIA PANEL

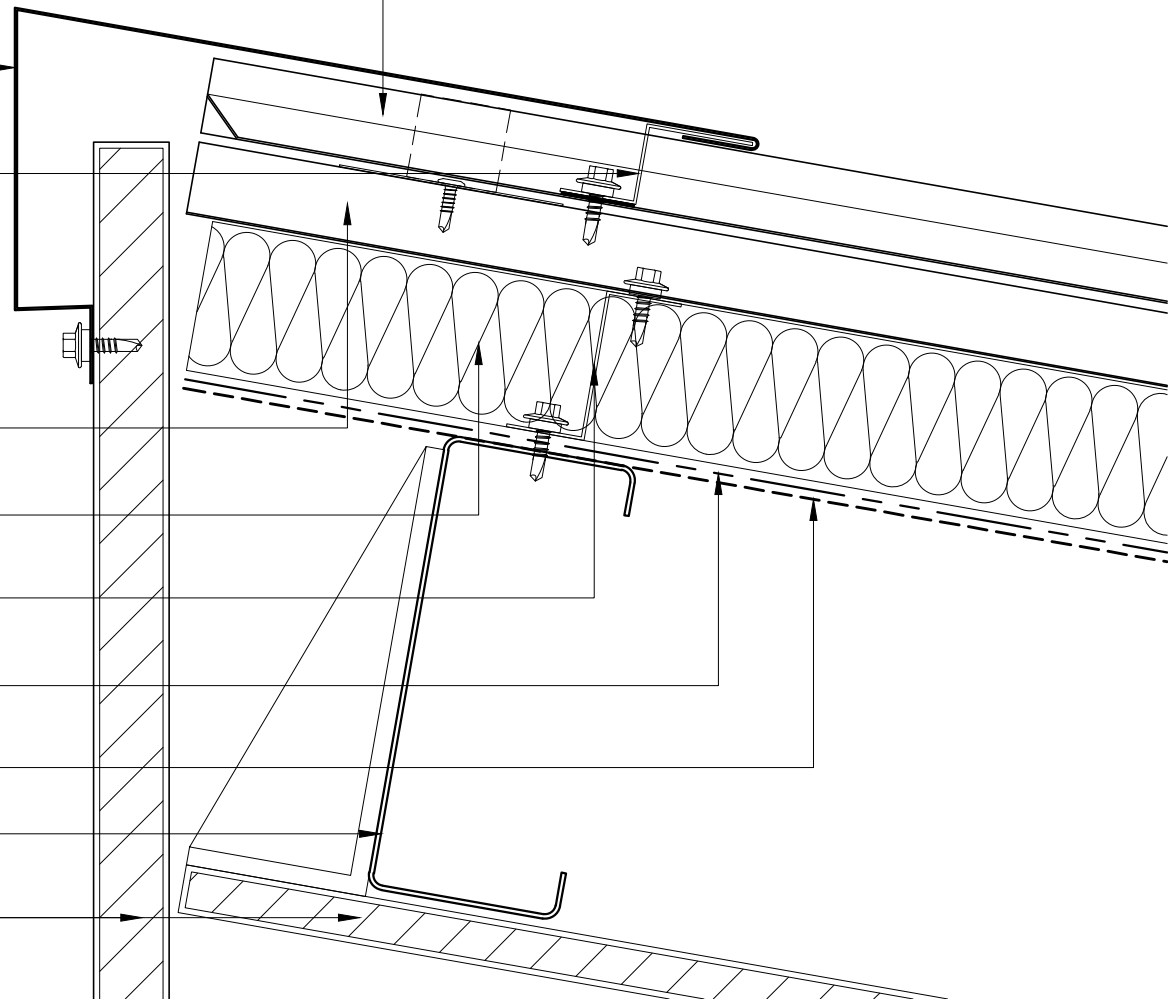

LCP BUILDING PRODUCTS PTE. LTD.

No. 6 Gul Circle, Singapore 629562

Telephone: (65) 6865 1550 Facsimile: (65) 6861 4218

A member of LCP Group of Companies

Email: lcp@lcp.sg

(CO. No. 200009173C)

REV	ISSUES/REVISIONS	DATE	BY
-COPYRIGHT RESERVED THIS DRAWING AND DESIGN IS AT ALL TIMES THE PROPERTY OF LCP-BUILDING PRODUCTS PTE. LTD. AND CANNOT BE USED WITHOUT LCP-BUILDING PRODUCTS PTE. LTD. WRITTEN CONSENT.			
-ALL DIMENSIONS MUST BE CHECKED BY THE CONTRACTOR BEFORE CONSTRUCTION.			
-THIS DETAIL DRAWING IS PURELY INDICATIVE AND IS A CONCEPTUAL DESIGN ONLY. ALL DESIGN MUST BE CHECKED BY LCP-BUILDING PRODUCTS PTE. LTD. TECHNICAL DEPARTMENT. PLEASE NOTE THIS DETAIL IS NOT A FINAL DESIGN AND CANNOT BE USED UNLESS AUTHORISED BY LCP-BUILDING PRODUCTS PTE. LTD..			

PROJECT: LCP SPANLOCK STANDARD DETAIL		
DRAWING TITLE: HIGH-END FLASHING DETAIL-2		
DWG. BY: BC	DATE: AUG 2005	PROJECT NO.:
CHKD. BY: MP	SCALE: N.T.S.	SHEET: 5 of 39